

BREEZE STANDARD HI-TORQUE



- ① Incredible torquing drive, sealing pressure and vibration resistance
- ② Inner liner to protect soft hose
- ③ Eight screw-threads are engaged in the band simultaneously
- ④ 7.9mm hexagonal slotted screw

Fixing traffic signs

The strongest worm-gear clamp made in the world today. Withstands more than 3 times the SAE torque requirements for Type F worm-gear clamps. The Hi-Torque Clamp is produced using components entirely manufactured from stainless steel.

The construction of the worm-drive housing on the band facilitates installation of a wide range of signs. The recommended tightening torque for secure and reliable installation is 16 Nm and the breaking torque is more than 20 Nm.

Advantages at a glance

- Very high break torque
- Quadra-Lock housing construction
- Secure and reliable installation
- No sharp edges to injure the installer
- Easy installation of two signs on one pole

Materials



Typical applications

- Traffic signs, street signs, billboards and illuminated signs installations
- Heavy duty sealing applications
- Agricultural
- Chemical Industry
- Food Processing
- Fluid Transfer

Dimensions

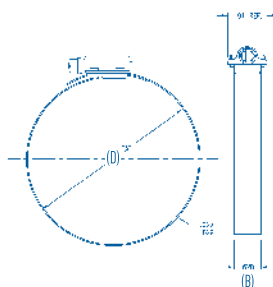

Specifications

BREEZE STANDARD HI-TORQUE				
Width (B mm)	Clamping ranges (D mm)	Clamping ranges (D in.)	Hexagonal slotted screw (mm)	S40 Product No.
16	25-45	1-1 3/4	7.9	0156 6021 035
	32-54	1 1/4-2 1/8		0156 6021 043
	45-67	1 3/4-2 5/8		0156 6021 056
	57-79	2 1/4-3 1/8		0156 6021 068
	70-92	2 3/4-3 5/8		0156 6021 081
	83-105	3 1/4-4 1/8		0156 6021 094
	95-118	3 3/4-4 5/8		0156 6021 106
	108-130	4 1/4-5 1/8		0156 6021 119
	121-143	4 3/4-5 5/8		0156 6021 132
	133-156	5 1/4-6 1/8		0156 6021 144
	146-168	5 3/4-6 5/8		0156 6021 157
	159-181	6 1/4-7 1/8		0156 6021 170
	172-194	6 3/4-7 5/8		0156 6021 183
	184-206	7 1/4-8 1/8		0156 6021 195
	197-219	7 3/4-8 5/8		0156 6021 208
	210-232	8 1/4-9 1/8		0156 6021 221